

# THERMOGRECA<sup>®</sup>

TRANSLUCENT BOX SECTION CORRUGATED SHEETS IN CELLULAR POLYCARBONATE  
FOR PITCHED COVERINGS ON INDUSTRIAL AND COMMERCIAL BUILDINGS

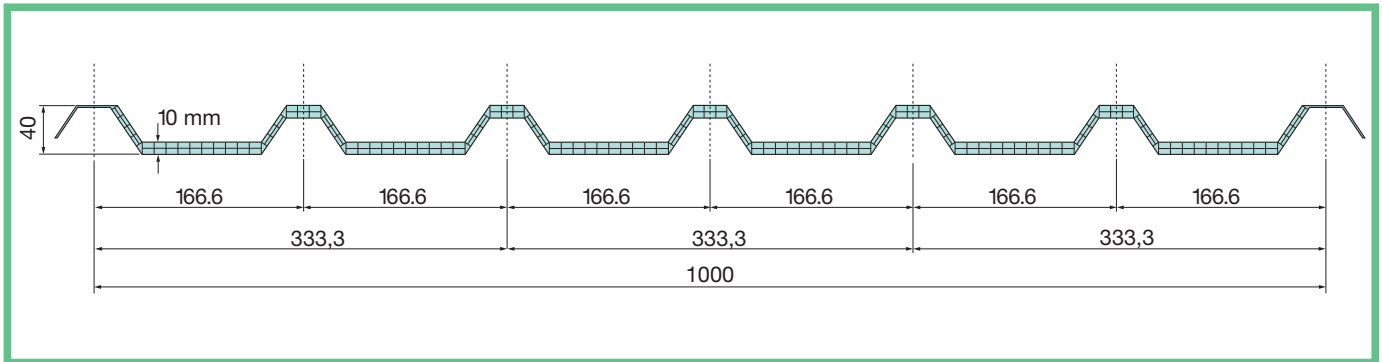

100G/7



SINGLE AND MULTIPLE SHEET FIXING OF BOX SECTION CORRUGATED SHEETS

polyú®

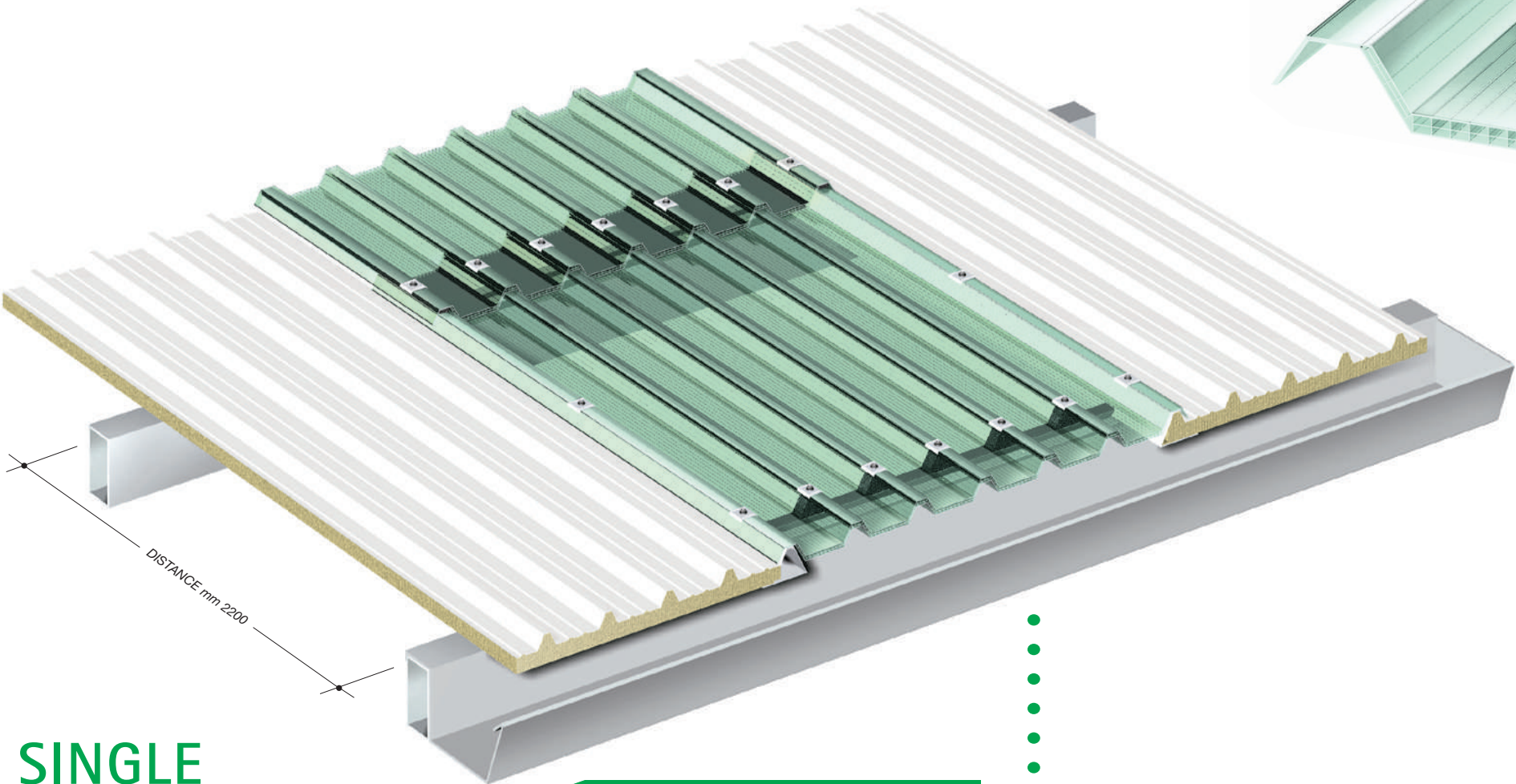

SINGLE SHEET FIXING

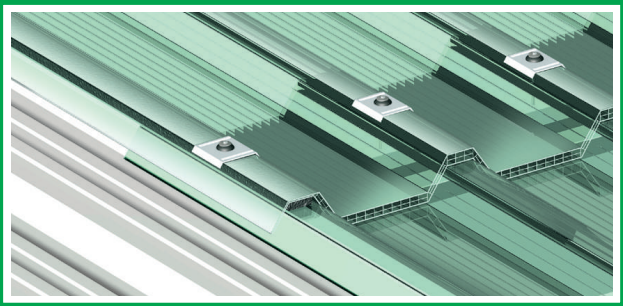

ENDLAP AND FIXING DETAIL

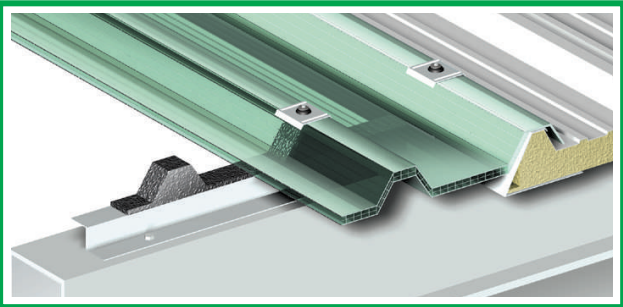

SIDELAP AND FIXING TO METAL DETAIL

LOAD BEARING CAPACITY WHEN SUPPORTED AT 2200 mm

QUANTITY LOADED			SHEET DEFLECTION mm
PASCAL	Kg/m <sup>2</sup>	Km/h	
250	25	70	15
500	50	100	40
750	75	125	50
1000	100	145	70
1250	125	165	75
1500	150	180	76
1750	175	195	85
2000	200	210	87
2250	225	225	93
2500	250	240	98
METAL SIDE RIB WIDTH	THERMOGRECA SIDE RIB WIDTH	THERMOGRECA SHEET PITCH	THERMOGRECA SIDE RIB HEIGHT
20	25		40
30	35	1000	40
40	45		40

N.B.: Table values are indicative, contact our technical staff for any information.

MULTIPLE SHEET FIXING

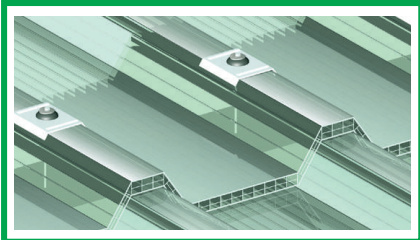

ENDLAP AND FIXING DETAIL

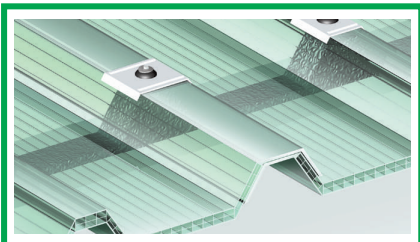

SIDELAP AND FIXING DETAIL

LOAD BEARING CAPACITY WHEN SUPPORTED AT 1350 mm

QUANTITY LOADED			SHEET DEFLECTION mm
PASCAL	Kg/m <sup>2</sup>	Km/h	
400	40	90	10
600	60	110	16
900	90	140	20
1200	120	160	30
1800	180	200	34
2200	220	220	53
2700	270	250	60
3100	310	270	68
3600	360	290	74

N.B.: Table values are indicative, contact our technical staff for any information.

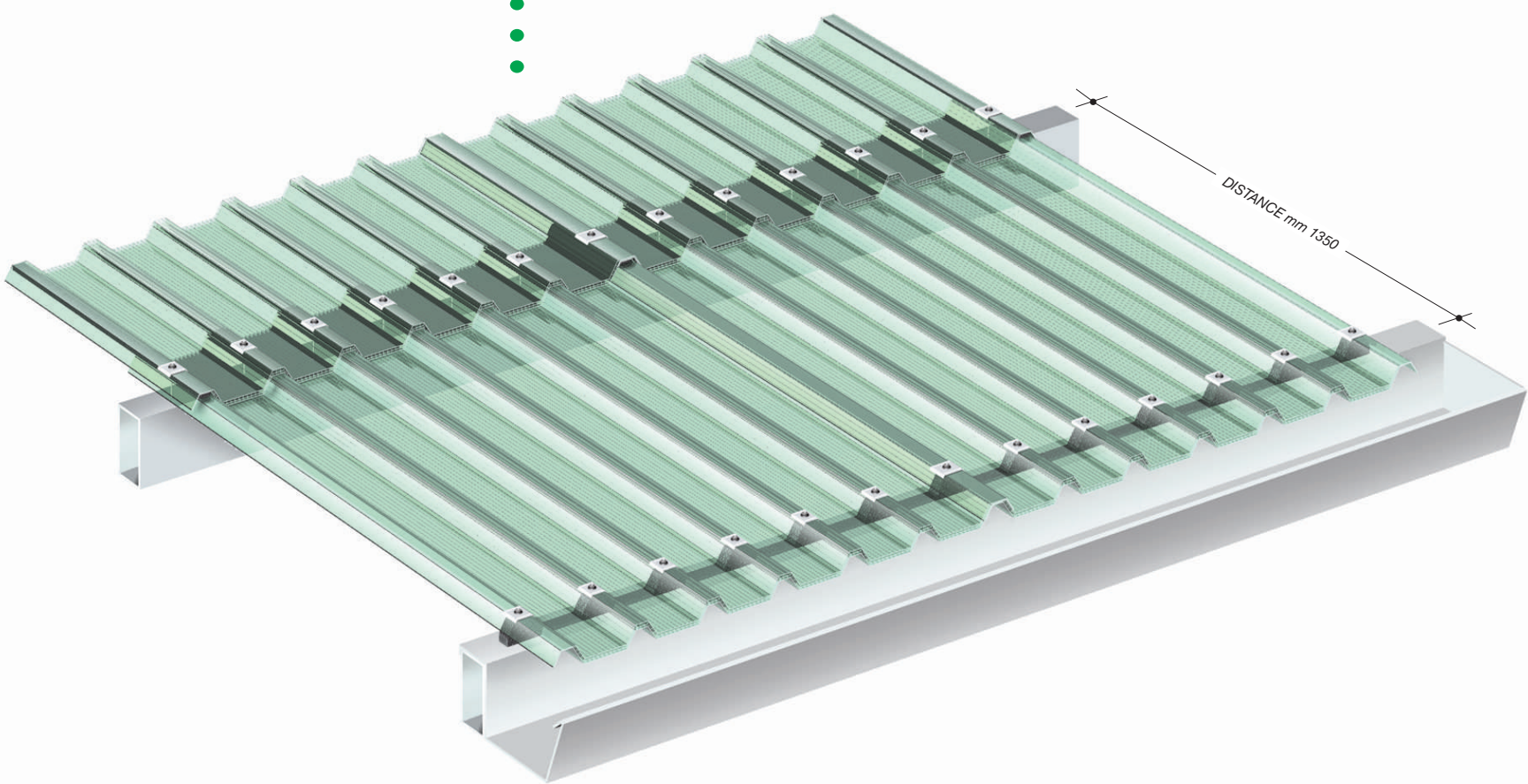



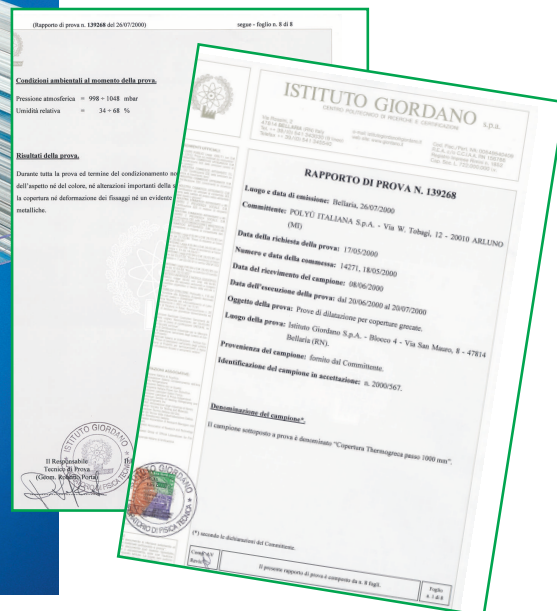
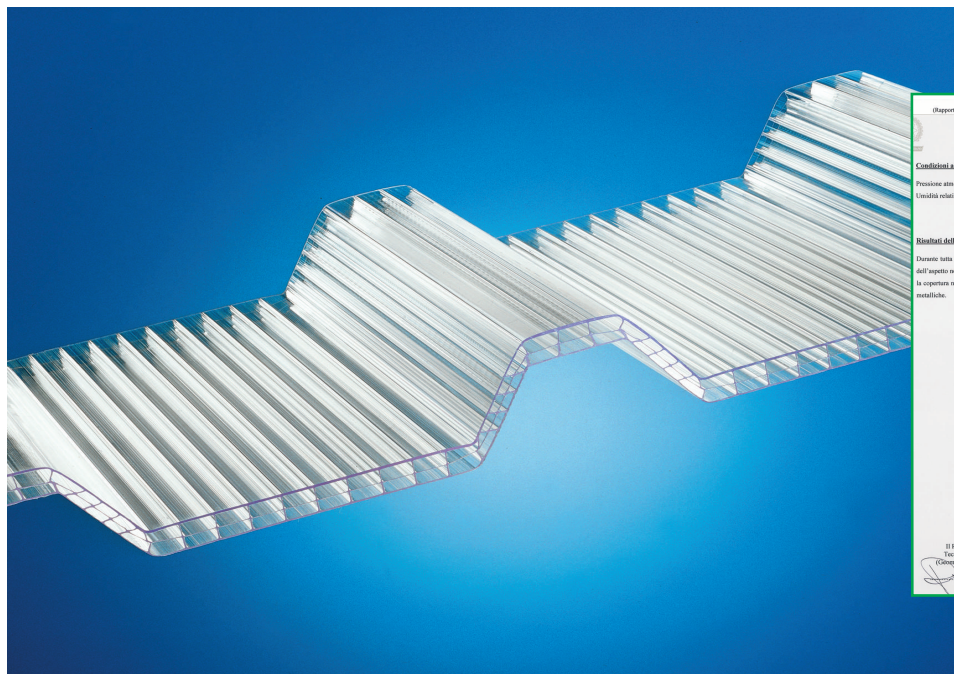

In answer to increasing demand, Polyù Italiana S.p.A. now introduces Thermogreca 1000 G/7. This is the only greca profile polycarbonate sheet with a triplewall structure which is directly obtained through extrusion.

An extremely robust product, Thermogreca 1000 G/7 has universal edges which fit most metal ribbed panels available on the market.

Overlapping of the heat sealed sheet ends enables shorter lengths of sheet to be used where necessary, thus reducing any material expansion.

Thanks to its good insulation properties, high light transmission and durability, Thermogreca 1000 G/7 is an excellent option in the area of translucent skylights.

## THERMOGRECA 1000 G/7 CHARACTERISTICS

PRODUCTION CHARACTERISTICS	Thickness	mm 10
	Structure	Triplewall
	Useful width	mm 1000 $\pm$ 5
	Sheet length	upon request (recommended length not over 7 m)
PHYSICAL-THERMIC CHARACTERISTICS	Thermal-insulating properties	$K=2,5 \text{ Kcal/m}^2 \text{ h}^\circ\text{C}$ / $W=2,9 \text{ W/m}^2 \text{ K}$
	Temperature working range	$-40^\circ\text{C} + 130^\circ\text{C}$
	Linear thermal expansion	$6,7 \times 10^{-5} \text{ mm/mm}^\circ\text{C}$
LIGHT TRANSMISSION PROPERTIES	Satined clear	72% $\pm$ 2
	Satined opal	52% $\pm$ 2

## TECHNICAL SPECIFICATIONS

Production of flat coverings with ribbed sheets extruded in cellular polycarbonate 10 mm thick • self-extinguishing as per class 1 (I) • K value =  $2,5 \text{ Kcal/m}^2 \text{ h}^\circ\text{C}$  • W value =  $2,9 \text{ W/m}^2 \text{ K}$  • in satined clear and opal colours • UV-protected • sheet width 1000 mm • manufactured to length, with possibility of pitched overlap.



SHEETS SUPPLIED WITH BOTH ENDS HEAT-SEALED

**polyù®**



# THERMOGRECA®

TRANSLUCENT BOX SECTION CORRUGATED SHEETS IN CELLULAR POLYCARBONATE FOR PITCHED COVERINGS AND GLAZING ON INDUSTRIAL AND COMMERCIAL BUILDINGS

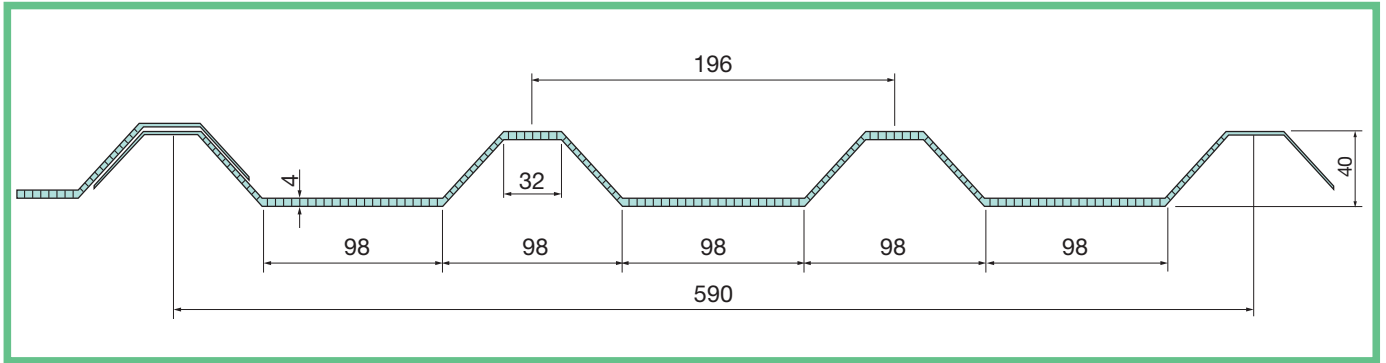

590GG/4



ROOFING AND GLAZING APPLICATIONS

polyú®

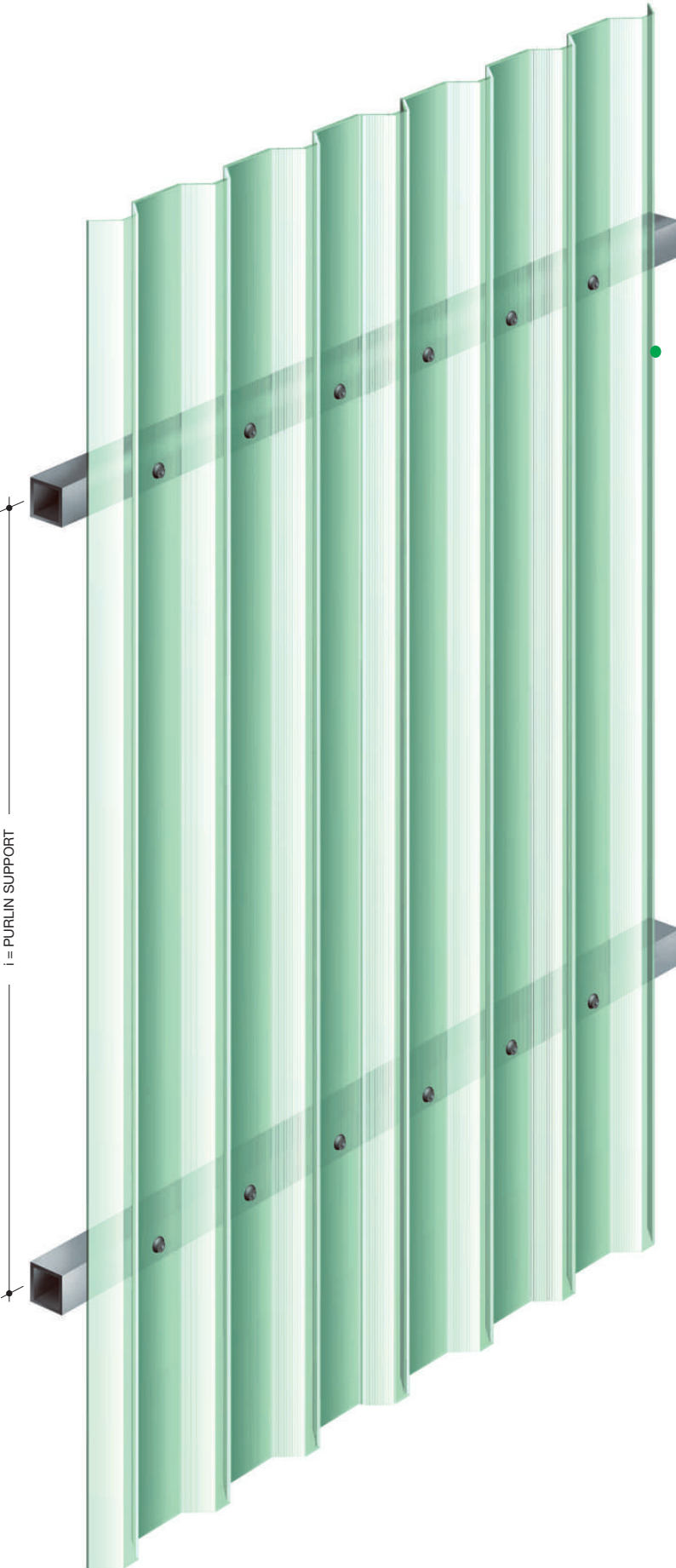

VERTICAL GLAZING APPLICATION

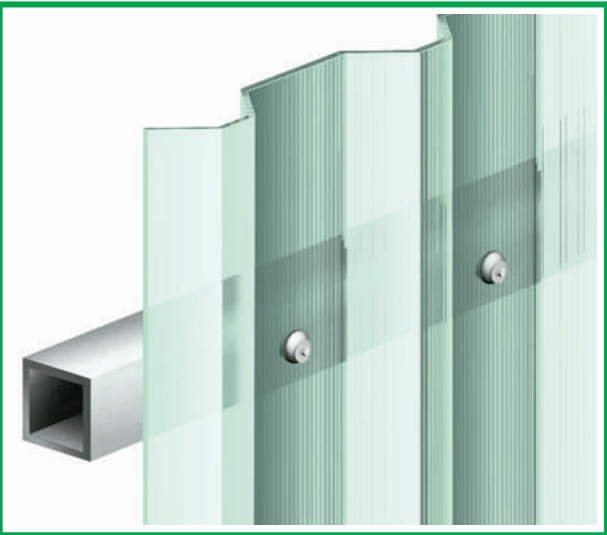

GLAZING SHEET FIXED IN THROUGH

LOAD BEARING CAPACITY WHEN SUPPORTED AT 1500 mm			
QUANTITY LOADED			SHEET DEFLECTION mm
daN/m <sup>2</sup>	Kg/m <sup>2</sup>	Km/h	
16	15	60	30
33	30	80	40
55	50	100	56
71	65	115	60
93	85	135	61
109	100	145	63
120	110	150	75
158	145	170	86
196	180	200	98
234	215	220	118

N.B.: Table values are indicative, contact our technical staff for any information.



MULTIPLE SHEET FIXING

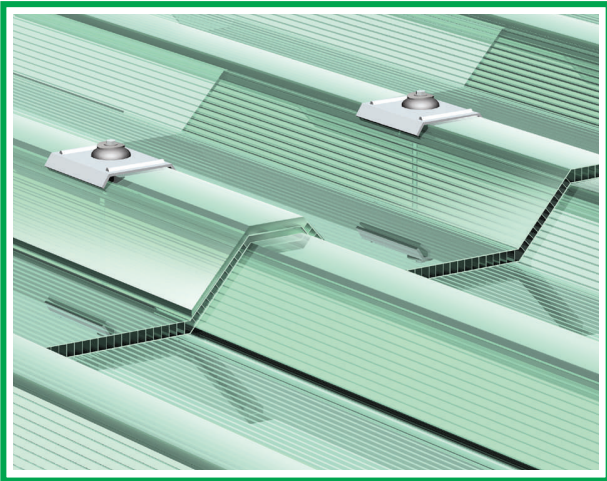
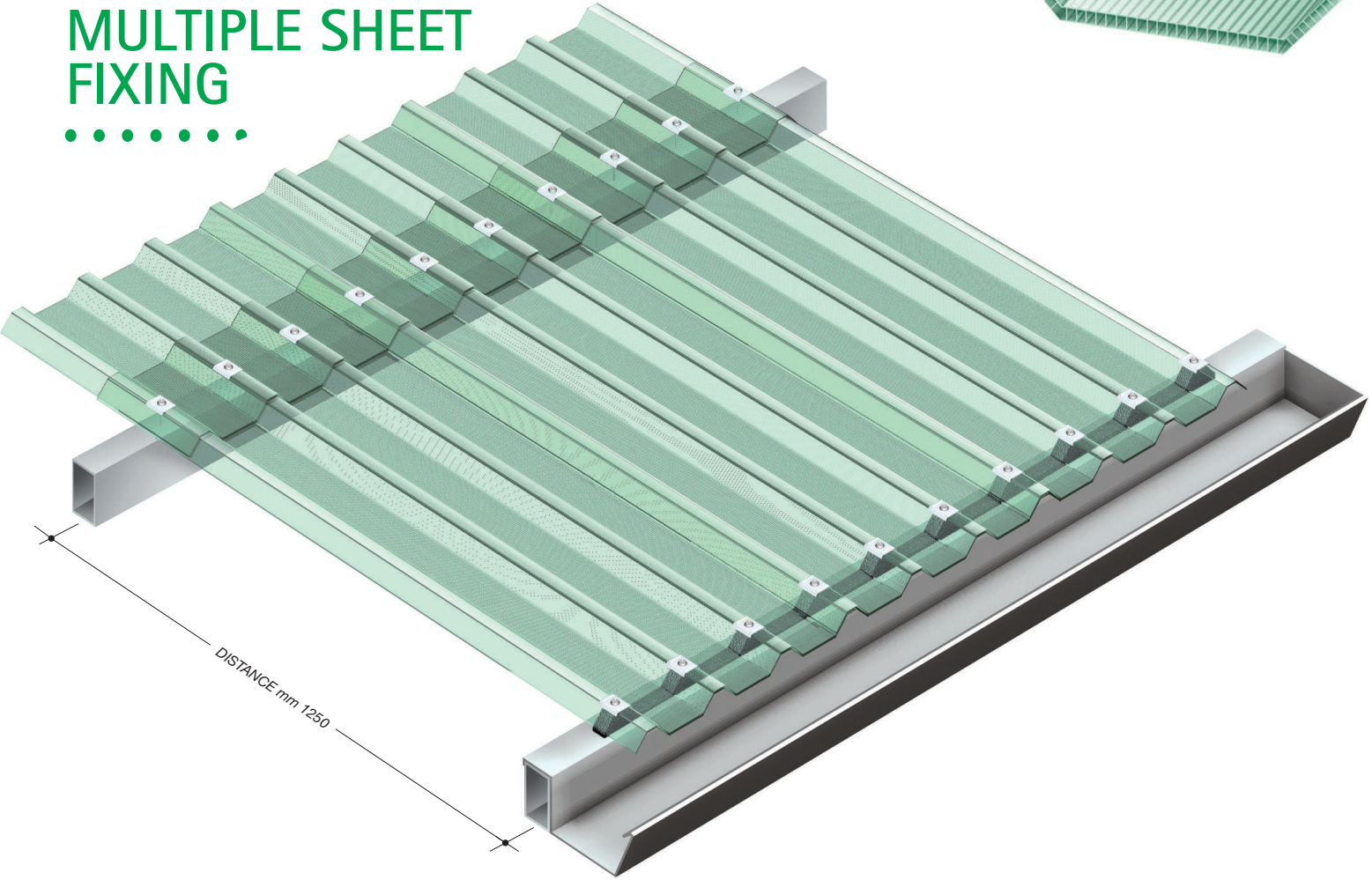

ENDLAP AND FIXING DETAIL

LOAD BEARING CAPACITY WHEN SUPPORTED AT 1250 mm			
QUANTITY LOADED			SHEET DEFLECTION mm
daN/m <sup>2</sup>	Kg/m <sup>2</sup>	Km/h	
43	40	90	35
87	80	130	42
131	120	160	70
174	160	190	100
218	200	210	120
261	240	240	140
327	300	270	160

N.B.: Table values are indicative, contact our technical staff for any information.



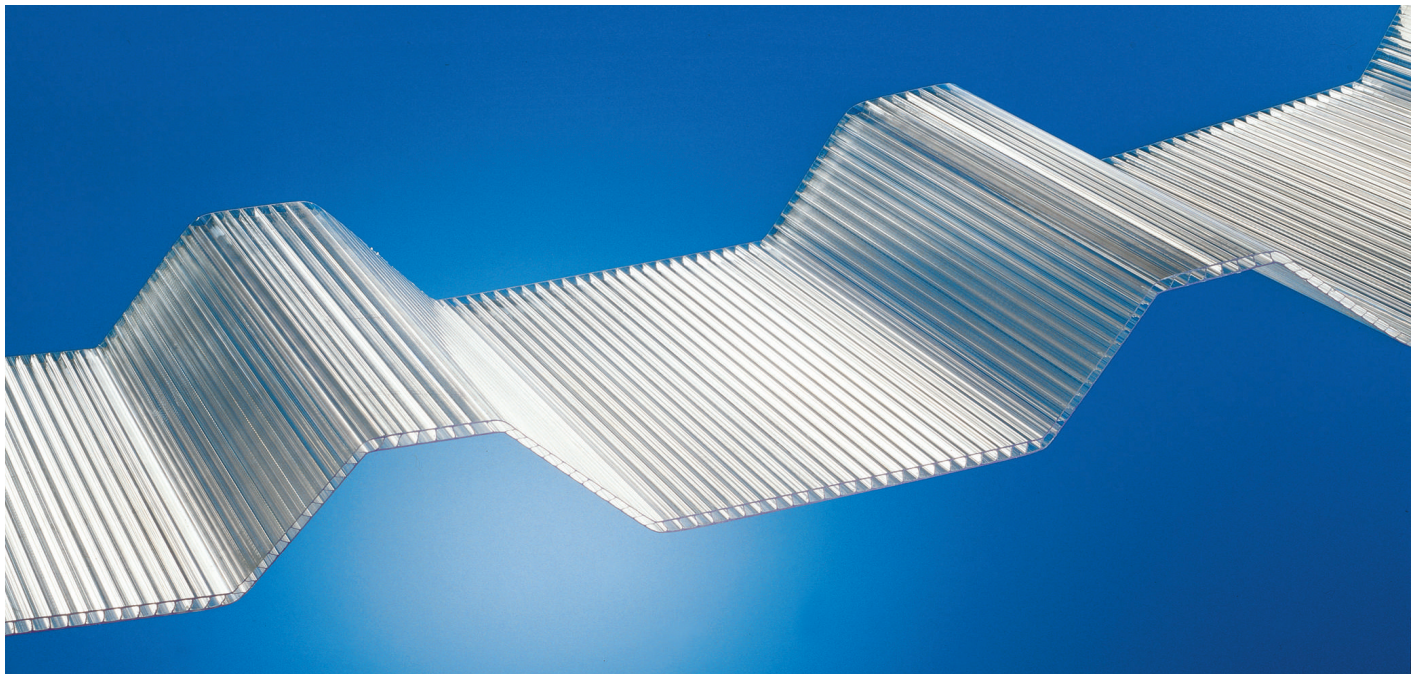

In addition to Thermogreca 1000 G/7, Polyù Italiana S.p.A. offers Thermogreca 590 G/4 in twinwall cellular polycarbonate. This is an ideal sheet for vertical glazing and translucent skylights applications which combines light weight materials with high sheet strength to give excellent performance characteristics.

Thermogreca 590 G/4's features allow expansion problems to be solved and its universal edge finish fits most metal ribbed sheets on the market. Balancing, high light transmission, durability and economy, Thermogreca 590 G/4 is an ideal solution for many translucent skylight applications.

**polyù®**

## THERMOGRECA 590 G/4 CHARACTERISTICS

PRODUCTION CHARACTERISTICS	Thickness	mm 4
	Structure	Twinwall
	Useful width	mm 590 ± 5
	Sheet length	upon request (recommended length not over 7 m)
PHYSICAL-THERMIC CHARACTERISTICS	Thermal-insulating properties	$K=3,6 \text{ Kcal/m}^2 \text{ h}^\circ \text{C}$ / $W=4,2 \text{ W/m}^2 \text{ K}$
	Temperature working range	- 40°C + 130°C
	Linear thermal expansion	$6,7 \times 10^{-5} \text{ mm/mm}^\circ \text{C}$
LIGHT TRANSMISSION PROPERTIES	Satined clear	83% ± 2
	Satined opal	75% ± 2

## TECHNICAL SPECIFICATIONS

■ Production of vertical glazings and flat coverings with ribbed sheets extruded in cellular polycarbonate • 4 mm thick • self-extinguishing as per class 1 (I) • K value = 3,6 Kcal/m<sup>2</sup> h°C • W value = 4,2 W/m<sup>2</sup> K • in satined clear and opal colours • UV-protected • sheet width 590 mm • manufactured to length, with possibility of pitched overlap.

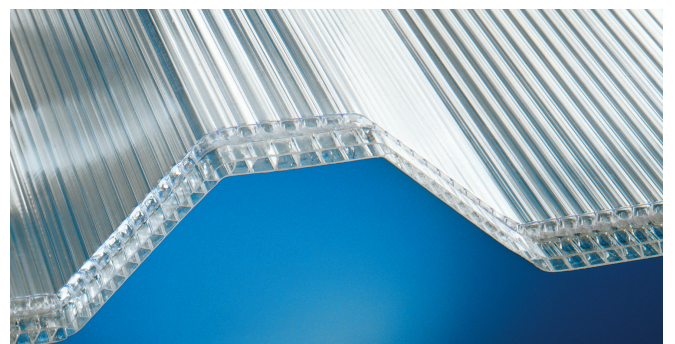

SHEET SUPPLIED WITH BOTH ENDS HEAT-SEALED



# SHEET ACCESSORIES

**polyù<sup>®</sup>**

**THERMONDA<sup>®</sup>**

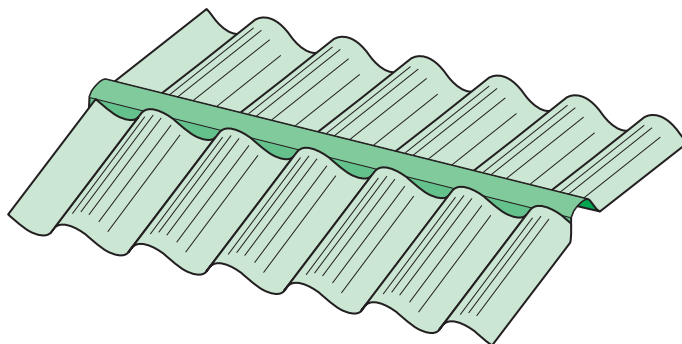

CORRUGATED CLEAR RIDGE IN EMBOSSED COMPACT PC

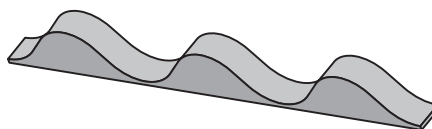

EAVES FILLER

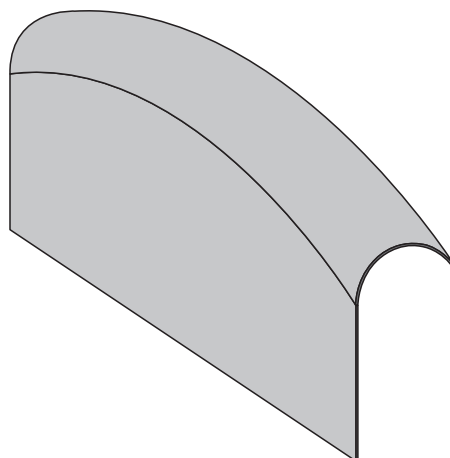

CLOSING HEADERS DEVELOPMENT 1520 mm

CLOSING HEADERS DEVELOPMENT 1830 mm

CLOSING HEADERS DEVELOPMENT 2130 mm

CLOSING HEADERS DEVELOPMENT 2440 mm

CLOSING HEADERS DEVELOPMENT 3700 mm



LONG SCREW FOR FIXING ON HIGH WAVE

SHORT SCREW FOR FIXING ON LOW WAVE



## THERMOGRECA® 1000 G/7

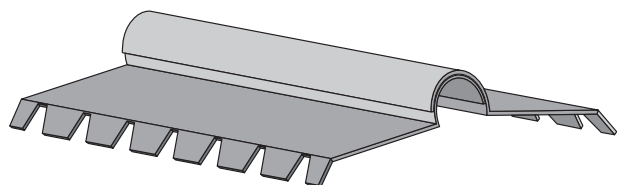

VARIABLE PRE-PAINTED INSULATED STEEL RIDGE WHITE/GRAY

VARIABLE PRE-PAINTED INSULATED STEEL RIDGE BROWN

VARIABLE PRE-PAINTED INSULATED ALUMINIUM RIDGE WHITE/GRAY

VARIABLE PRE-PAINTED INSULATED ALUMINIUM RIDGE BROWN

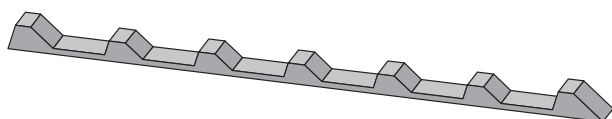

BLACK SPACER - mm 30x10 h

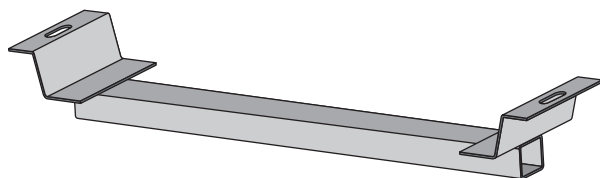

MIDDLE PURLIN IN GALVANIZED STEEL

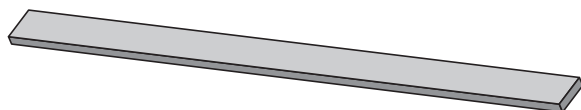

ADHESIVE BLACK GASKET - SECTION 20x10 mm

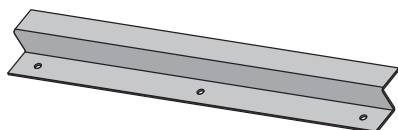

METAL SPACER

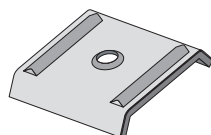

ALUMINIUM CAP WITH GASKET



LONG SCREW FOR FIXING ON HIGH RIB

## THERMOGRECA® 590 G/4

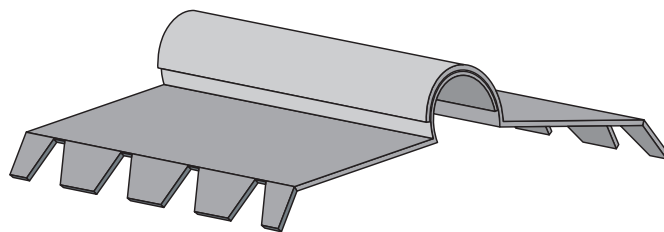

VARIABLE PRE-PAINTED INSULATED STEEL RIDGE WHITE/GRAY

VARIABLE PRE-PAINTED INSULATED STEEL RIDGE BROWN

VARIABLE PRE-PAINTED INSULATED ALUMINIUM RIDGE WHITE/GRAY

VARIABLE PRE-PAINTED INSULATED ALUMINIUM RIDGE BROWN

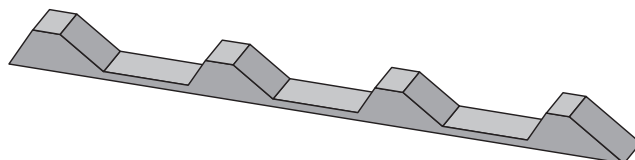

BLACK SPACER - mm 30x10 h

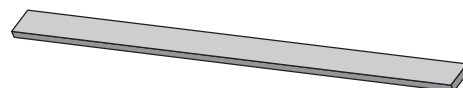

ADHESIVE BLACK GASKET - SECTION 12x3 mm

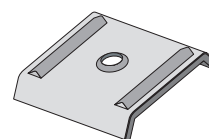

ALUMINIUM CAP WITH GASKET

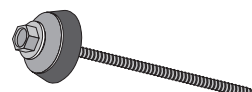

LONG SCREW FOR FIXING ON HIGH RIB

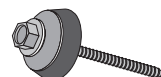

SHORT SCREW FOR FIXING ON LOW RIB